

Paintworks Phase 3 Public Arts Plan

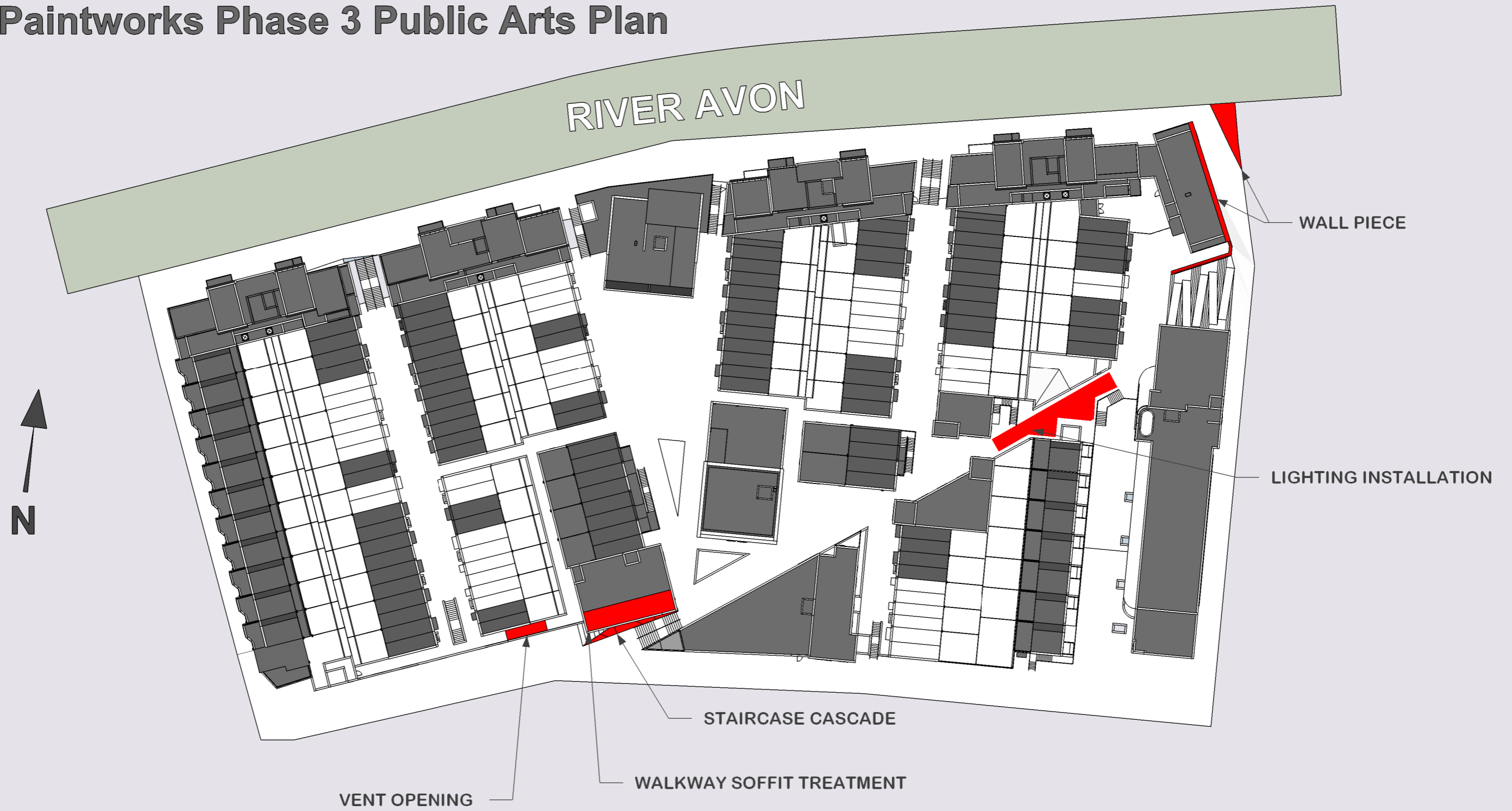

Vent Opening

Adjacent to the main paved area leading into Phase 3 is a 7m long x 2m high opening leading into the underground car park. This is where the main air extraction fans will be sited.



There will be a level of natural air flow through this opening as well as times when the fans are in operation providing a source of mechanically forced air movement.



All surfaces and columns within the opening will be constructed from flat faced concrete.



Walkway Soffit Piece

Adjacent to the main staircases leading up into the high street is a covered walkway formed by the building above. This soffit is approximately 16m long x just under 4m wide.



As this area is visually prominent from below it creates an excellent opportunity for an artist to conceive a piece that will enhance it. There is also an ideal opportunity to further enhance any installation by using complementary light sources.

The soffit will be flat face concrete construction.



Viewed from High Street level



Approximate dimensions

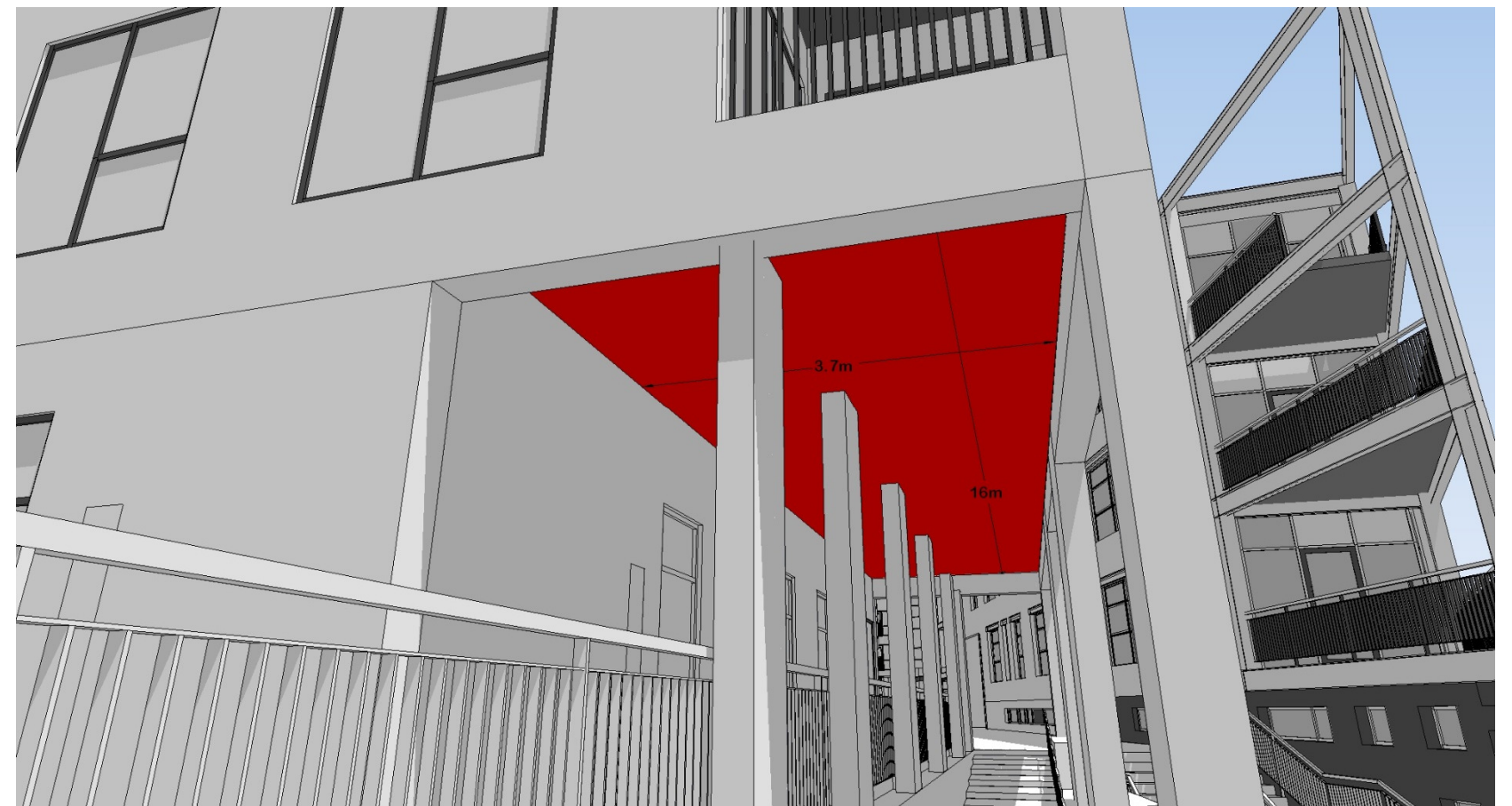

Staircase Cascade

Sitting between the two large flights of stairs which lead up into the main high street of Phase 3 is a series of raised concrete forms.

They range in size and shape numbering five in total. At present they are just flat faced monoliths.

This area could be considered as the main pedestrian access into the heart of the development and any intervention occupying this position would be highly prominent very close to the users of the stairs.

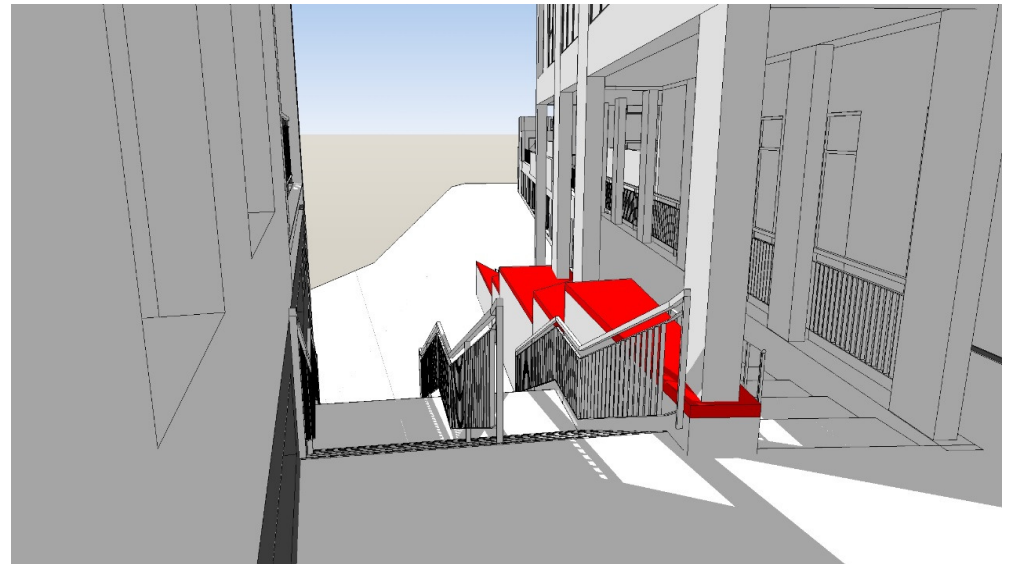
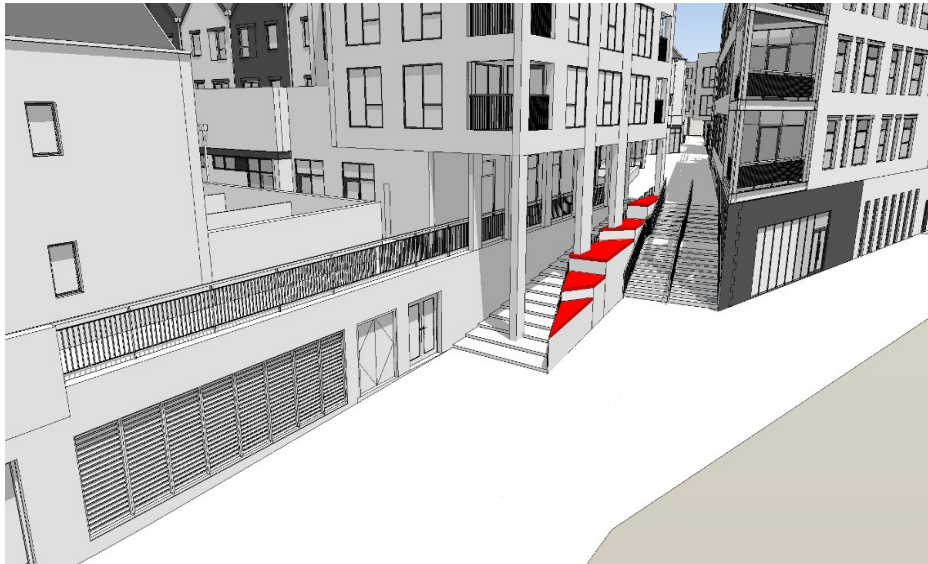

Light Installation

Situated in the heart of the development is the high street.

At the Eastern end of this main route there is an opportunity to create an artwork based on the use of light or lighting.

Ideally the artwork will act as a beacon within the development during both day and night.

There is no specific criteria as to where this piece will be sited apart from the guide created by the red area demarked in the accompanying contextual graphic.



Viewed from West end of High Street



Viewed from East end of High Street



Wall & Adjacent Landscaping

At the very Eastern end of the development there is the pedestrian access from Sparky Evans Park bridge and from the lane that leads onto the A4 Bath Rd.

At the base of one of the tallest buildings in Phase 3 is a clear section of wall which wraps around the end elevation and up the combined stairs and ramp into Paintworks Ph3.

This presents a large clear space for a graphics based artwork. The wall will be finished in flat faced concrete.

Opposite this wall there is also a small area of open land which, if desired by the artist, could be included within the scope of any artwork concept.

